

# Whelan Double-Ended Suture Wire Passer

Designed by Edward J. Whelan, III, MD

*Passer guide and malleable passer designed to pass suture wires around a bone*

The passer guide is placed around the bone, and the thin malleable passer is inserted at the handle end and follows the grooved passer around. The suture wire (up to 18 gauge) is attached to the keyholed end of the passer, which can then be reversed out of the passer, drawing the suture wire around the bone.

Insert passer into guide to pass around the bone

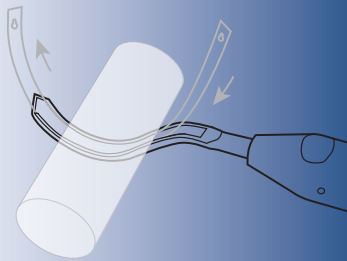

Attach suture wire, then draw the passer/suture wire back around the bone

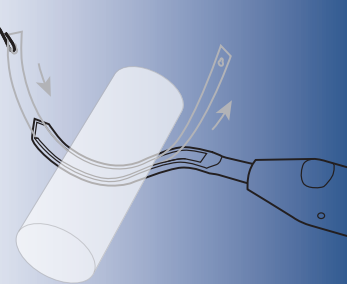

Set includes Passer Guide, two Passers, and a sterilization case.

**PRODUCT NO'S:**

8300-00 [Set]

**Also available individually:**

8300-01 [Passer Guide]  
Overall Length: 8.125" (20,6 cm)  
Outside Width: 9 mm  
Inside Groove Width: 6.5 mm

8300-02 [Passer]  
Overall Length: 7.5" (19,1 cm)  
Width: 4.6 mm

1025 [Sterilization Case]



ISO 13485:2016

FREE TRIAL ON MOST INSTRUMENTS

**INNOMED** 



103 Estus Drive, Savannah, GA 31404  
www.innomed.net info@innomed.net

912.236.0000 Phone  
912.236.7766 Fax

Innomed-Europe Tel. +41 41 740 67 74  
Fax +41 41 740 67 71

1.800.548.2362

© 2021 Innomed, Inc.