

# Alvi Small Charnley Style Locking Frame Set

Designed by Hasham Alvi, MD

*A self-retaining frame and retractor system designed for use during anterior total hip arthroplasty, the blades help retract the hip capsule and musculature, permitting an unobstructed view of the acetabulum while freeing an assistant*

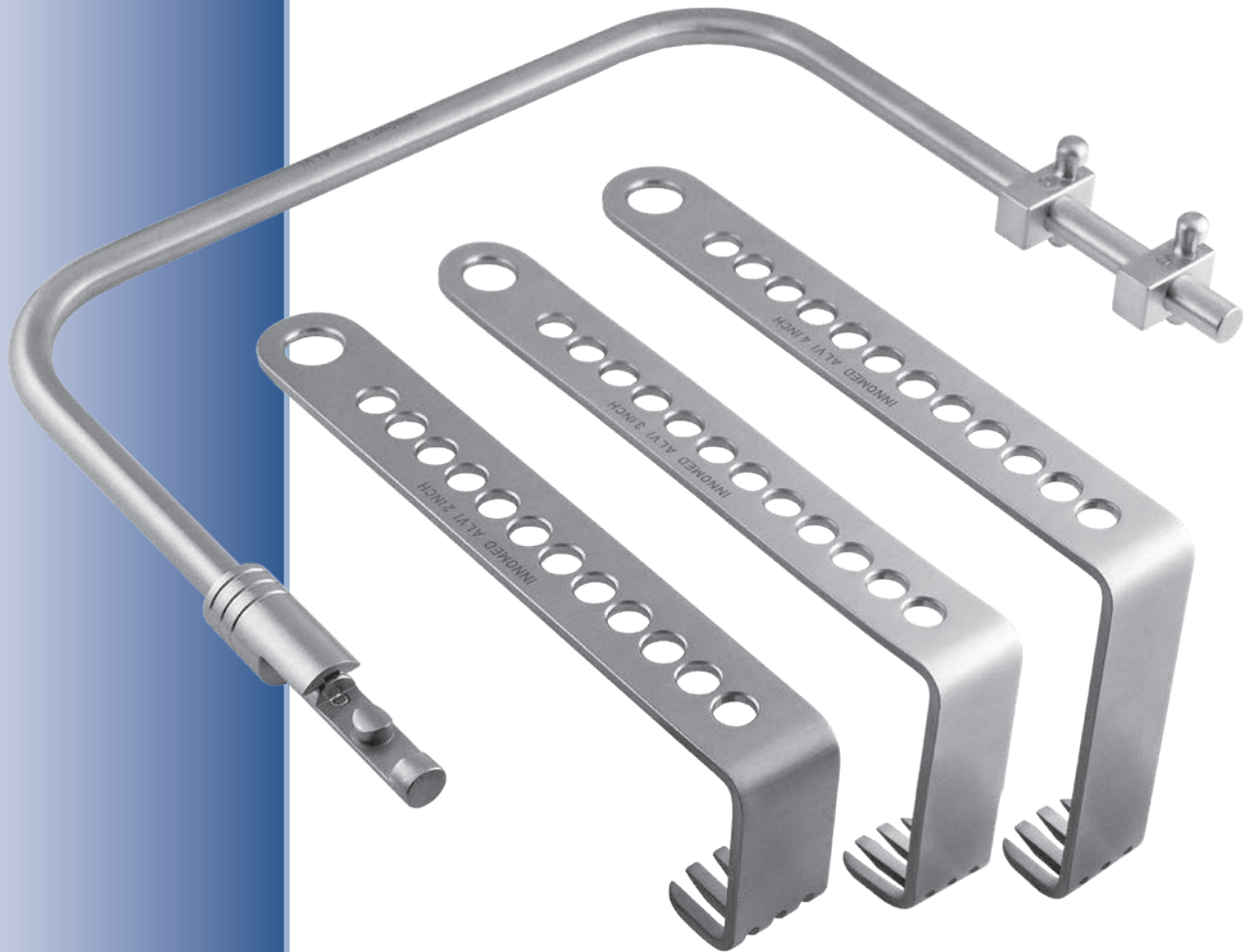

Set comes with locking frame (7425-01) and one each of the three blade sizes: 2" (7425-02), 3" (7425-03), and 4" (7425-04)

PRODUCT NO'S:
7425-00 [Set] Set includes: (1) 7425-01, (1) 7425-02, (1) 7425-03, (1) 7425-04
<b>Also available individually:</b>
7425-01 [Small Charnley Style Locking Frame] Dimensions: 9" x 7" (22,9 cm x 17,8 cm)
7425-02 [2" Tapered Blade] Blade Depth: 2" (5,1 cm) Handle Length: 7" (17,8 cm) Blade Width: 1" (2,54 cm)
7425-03 [3" Tapered Blade] Blade Depth: 3" (7,6 cm) Handle Length: 7" (17,8 cm) Blade Width: 1" (2,54 cm)
7425-04 [4" Tapered Blade] Blade Depth: 4" (10,2 cm) Handle Length: 7" (17,8 cm) Blade Width: 1" (2,54 cm)



ISO 9001:2008 • ISO 13485:2003

FREE TRIAL ON MOST INSTRUMENTS

Scan to  
Launch Our  
Website



**INNOMED** 



103 Estus Drive, Savannah, GA 31404  
www.innomed.net info@innomed.net

912.236.0000 Phone  
912.236.7766 Fax

Innomed-Europe Tel. +41 41 740 67 74  
Fax +41 41 740 67 71

1.800.548.2362